

CLI05 I.C. Core Cam Lock Assembly Instructions

CLI05-0312Y_

Locked @ 3

Open @ 12

Key Retaining (key removable in locked position only)

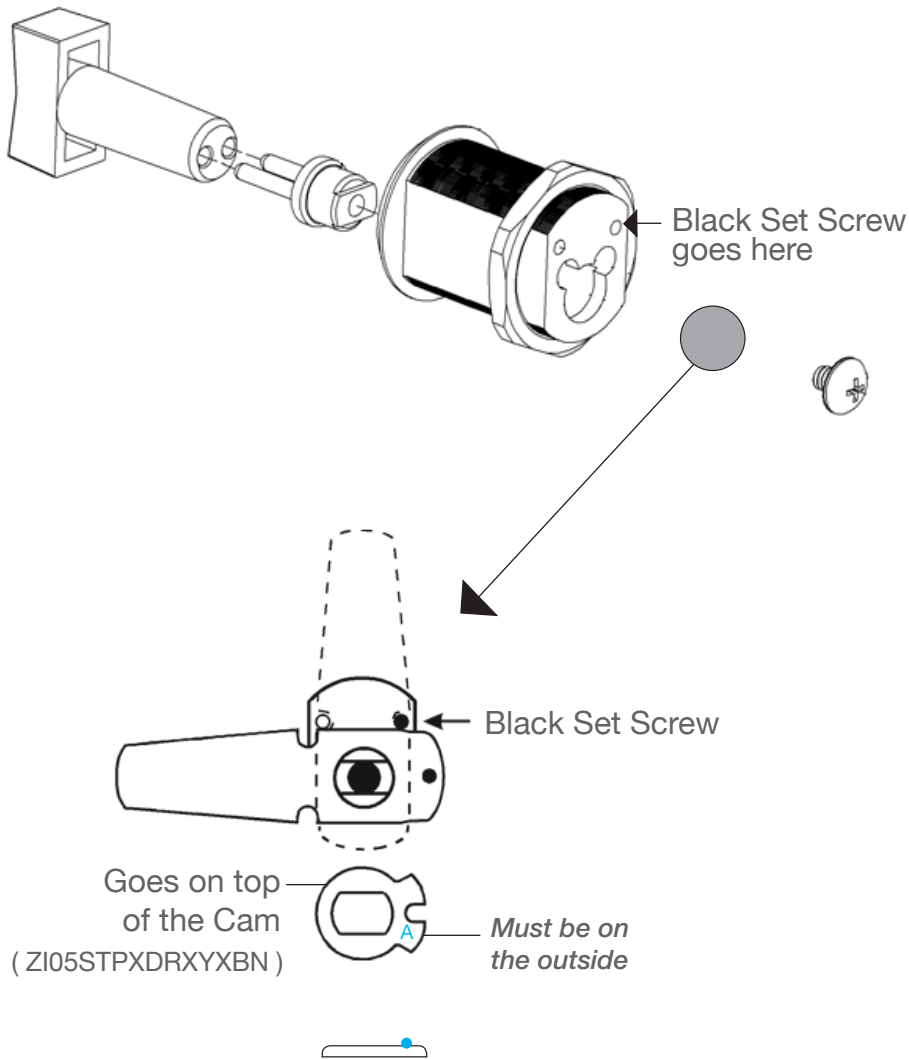

WOOD INSTALLATION

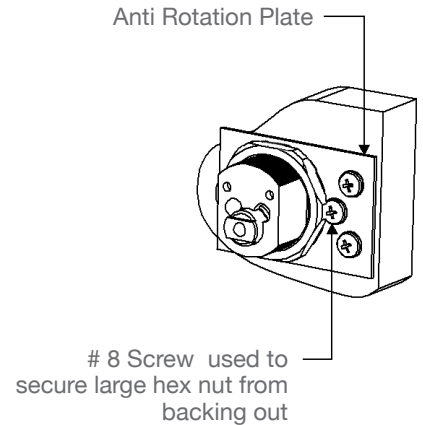

METAL INSTALLATION

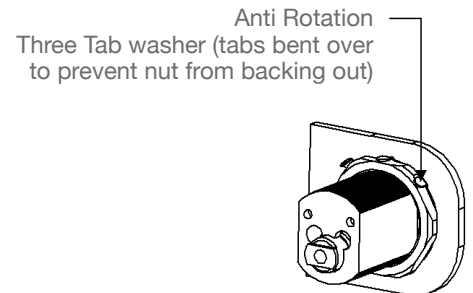

Note: A double "D" hole is required on the glass to prevent the lock from rotating.

GLASS INSTALLATION

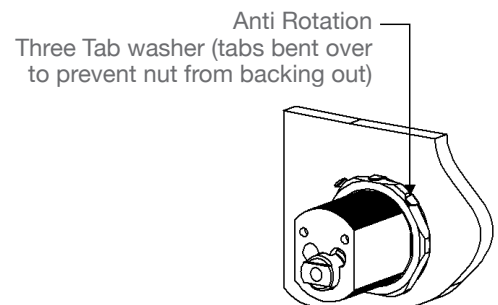

Note: A double "D" hole is required on the glass to prevent the lock from rotating.

For this and more assembly/installation instructions go to www.kenstan.com click on Customer Support then click on "Installation Instructions"

CLI05 I.C. Core Cam Lock Assembly Instructions

CLI05-0912Y_

Locked @ 9

Open @ 12

Key Retaining (key removable in locked position only)

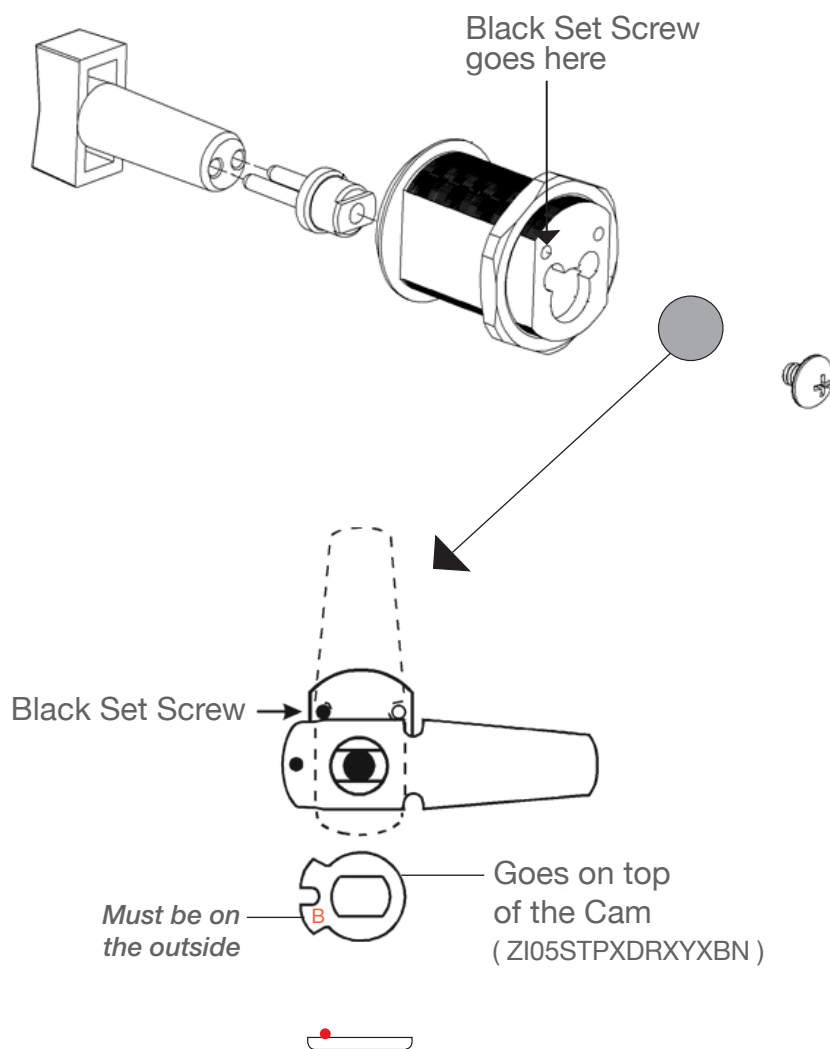

WOOD INSTALLATION

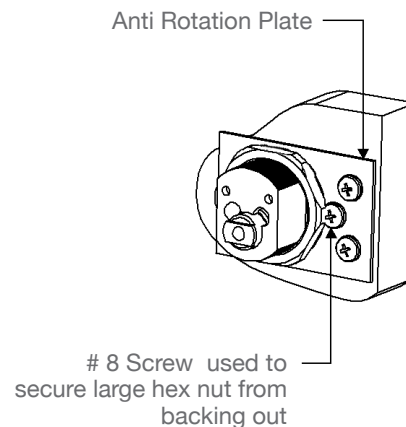

METAL INSTALLATION

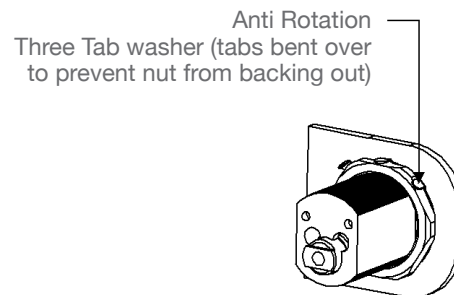

Note: A double "D" hole is required on the glass to prevent the lock from rotating.

GLASS INSTALLATION

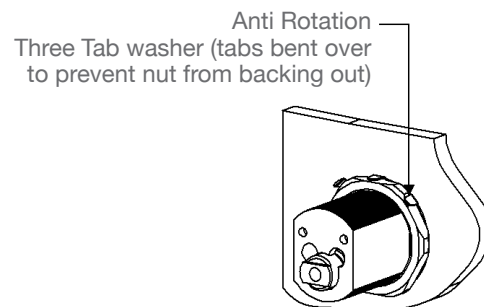

Note: A double "D" hole is required on the glass to prevent the lock from rotating.

For this and more assembly/installation instructions go to www.kenstan.com click on Customer Support then click on "Installation Instructions"

CLI05-12 03N_
or
CLI05-0312N_

Kenstan

LOCK COMPANY

Manufacturer of Fine Showcase and Cabinet Locks

CLI05 I.C. Core Cam Lock Assembly Instructions

CLI05-12 03N_

Locked @ 12
Open @ 3
Not Key Retaining (key removable in locked or unlocked position)

or

CLI05-0312N_

Locked @ 3
Open @ 12
Not Key Retaining (key removable in locked or unlocked position)

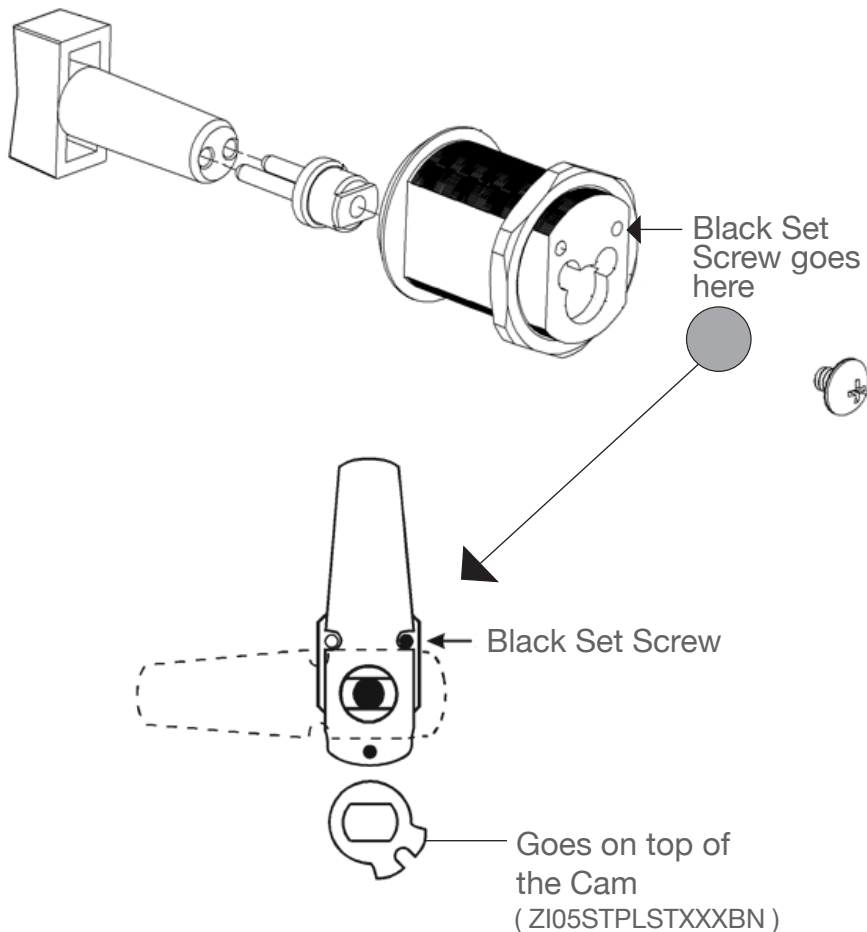

For this and more assembly/installation instructions go to www.kenstan.com click on Customer Support then click on "Installation Instructions"

WOOD INSTALLATION

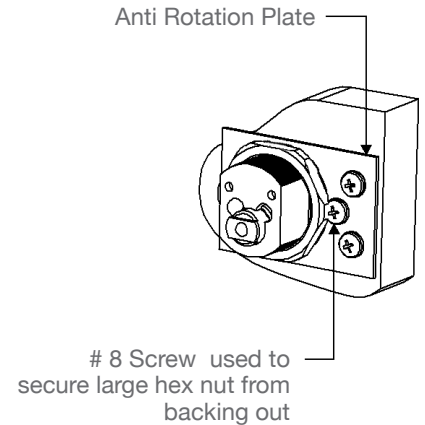

METAL INSTALLATION

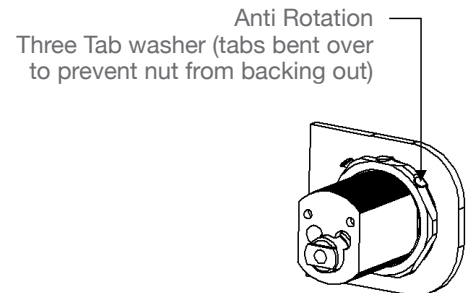

Note: A double "D" hole is required on the glass to prevent the lock from rotating.

GLASS INSTALLATION

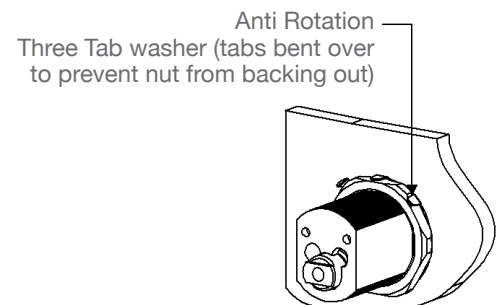

Note: A double "D" hole is required on the glass to prevent the lock from rotating.

CLI05 I.C. Core Cam Lock Assembly Instructions

CLI05-12 03Y_

Locked @ 12

Open @ 3

Key Retaining (key removable in locked position only)

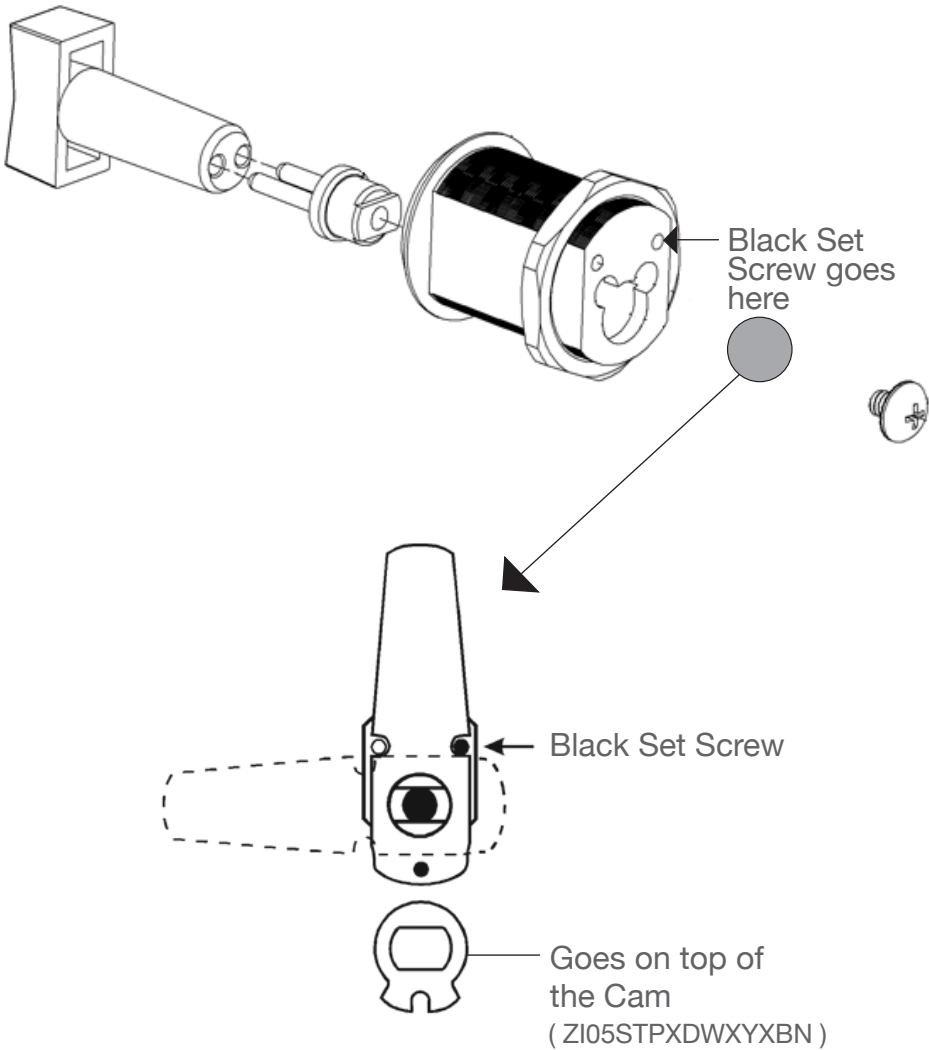

WOOD INSTALLATION

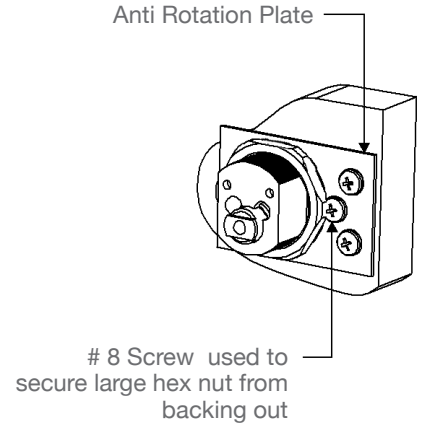

METAL INSTALLATION

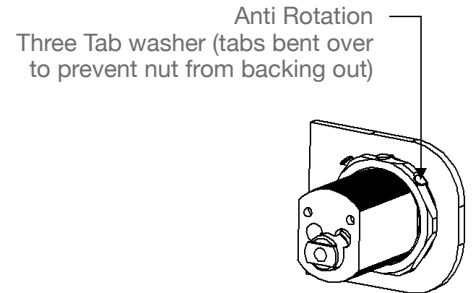

Note: A double "D" hole is required on the glass to prevent the lock from rotating.

GLASS INSTALLATION

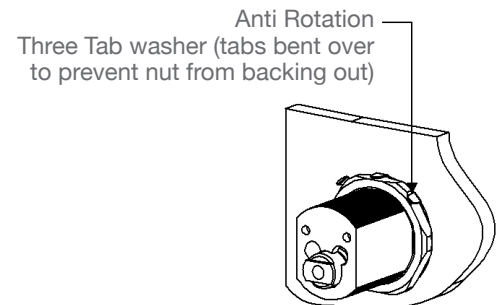

Note: A double "D" hole is required on the glass to prevent the lock from rotating.

For this and more assembly/installation instructions go to www.kenstan.com click on Customer Support then click on "Installation Instructions"

CLI05-12 09N_
or
CLI05-0912N_

Kenstan

LOCK COMPANY

Manufacturer of Fine Showcase and Cabinet Locks

CLI05 I.C. Core Cam Lock Assembly Instructions

CLI05-12 09N_

Locked @ 12

Open @ 9

Not Key Retaining (key removable in locked or unlocked position)

or

CLI05-0912N_

Locked @ 9

Open @ 12

Not Key Retaining (key removable in locked or unlocked position)

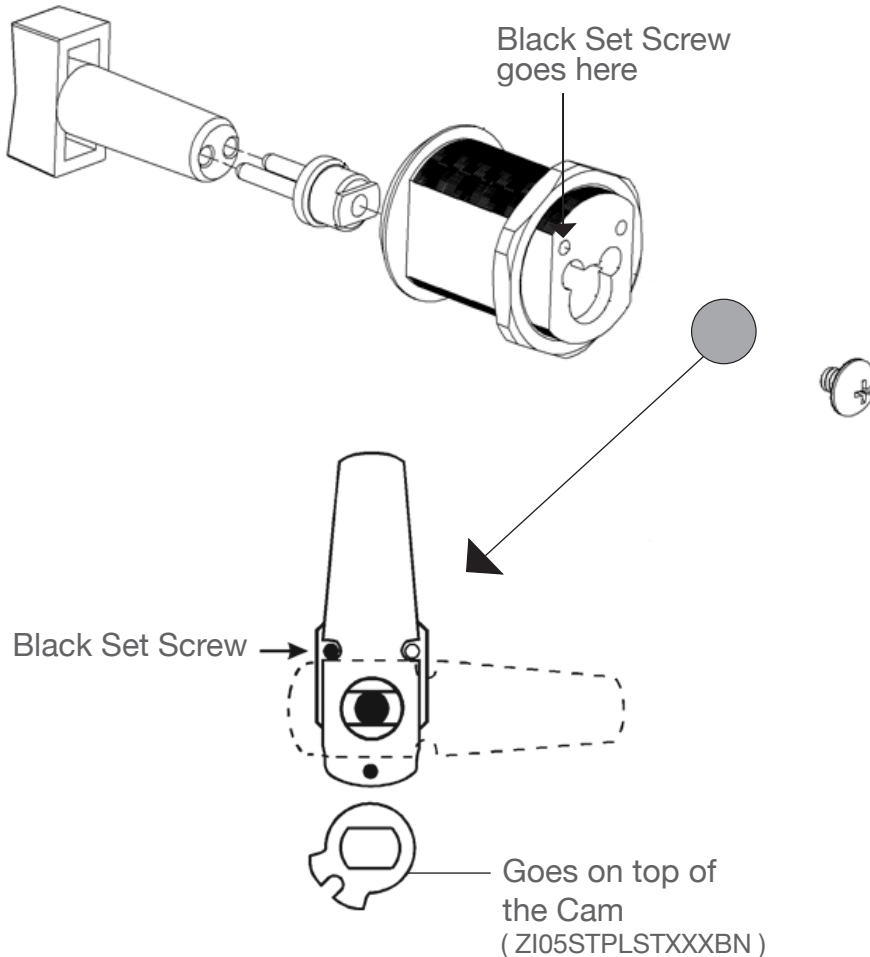

For this and more assembly/installation instructions go to www.kenstan.com click on Customer Support then click on "Installation Instructions"

WOOD INSTALLATION

Anti Rotation Plate

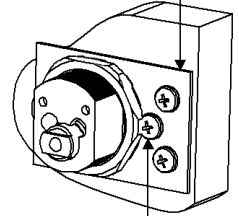

8 Screw used to secure large hex nut from backing out

METAL INSTALLATION

Anti Rotation

Three Tab washer (tabs bent over to prevent nut from backing out)

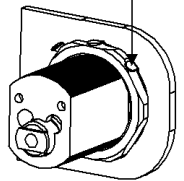

Note: A double "D" hole is required on the glass to prevent the lock from rotating.

GLASS INSTALLATION

Anti Rotation

Three Tab washer (tabs bent over to prevent nut from backing out)

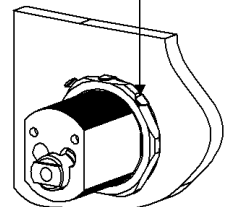

Note: A double "D" hole is required on the glass to prevent the lock from rotating.

Manufacturer of Fine Showcase and Cabinet Locks

CLI05 I.C. Core Cam Lock Assembly Instructions

CLI05-12 09Y_

Locked @ 12

Open @ 9

Key Retaining (key removable in locked position only)

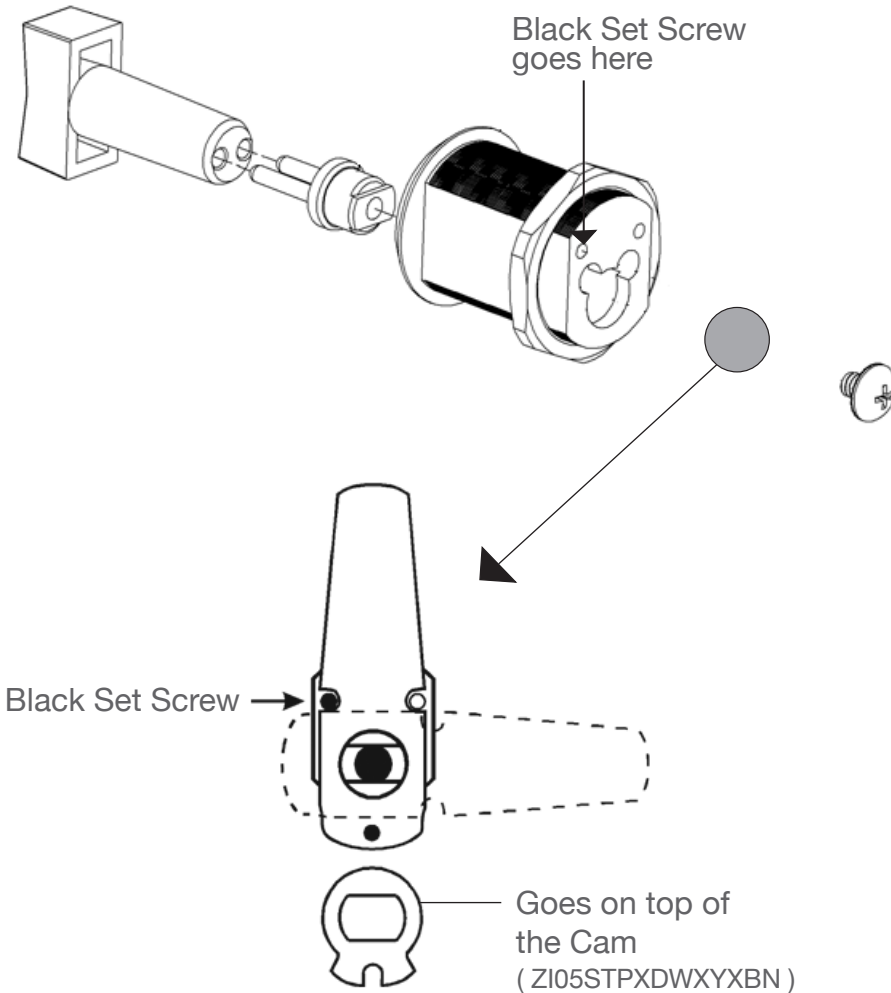

WOOD INSTALLATION

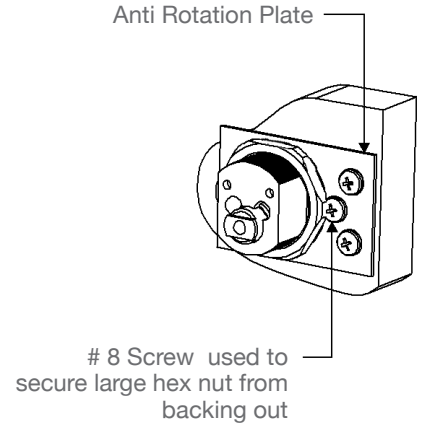

METAL INSTALLATION

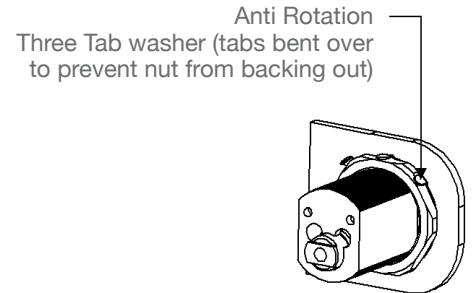

Note: A double "D" hole is required on the glass to prevent the lock from rotating.

GLASS INSTALLATION

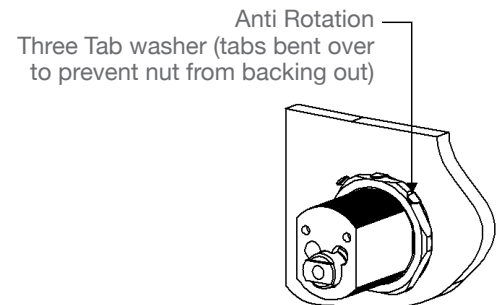

Note: A double "D" hole is required on the glass to prevent the lock from rotating.

For this and more assembly/installation instructions go to www.kenstan.com click on Customer Support then click on "Installation Instructions"

CLI05-03 06N_
or
CLI05-0603N_

Kenstan

LOCK COMPANY

Manufacturer of Fine Showcase and Cabinet Locks

CLI05 I.C. Core Cam Lock Assembly Instructions

CLI05-03 06N_

Locked @ 3

Open @ 6

Not Key Retaining (key removable in locked or unlocked position)

or

CLI05-0603N_

Locked @ 6

Open @ 3

Not Key Retaining (key removable in locked or unlocked position)

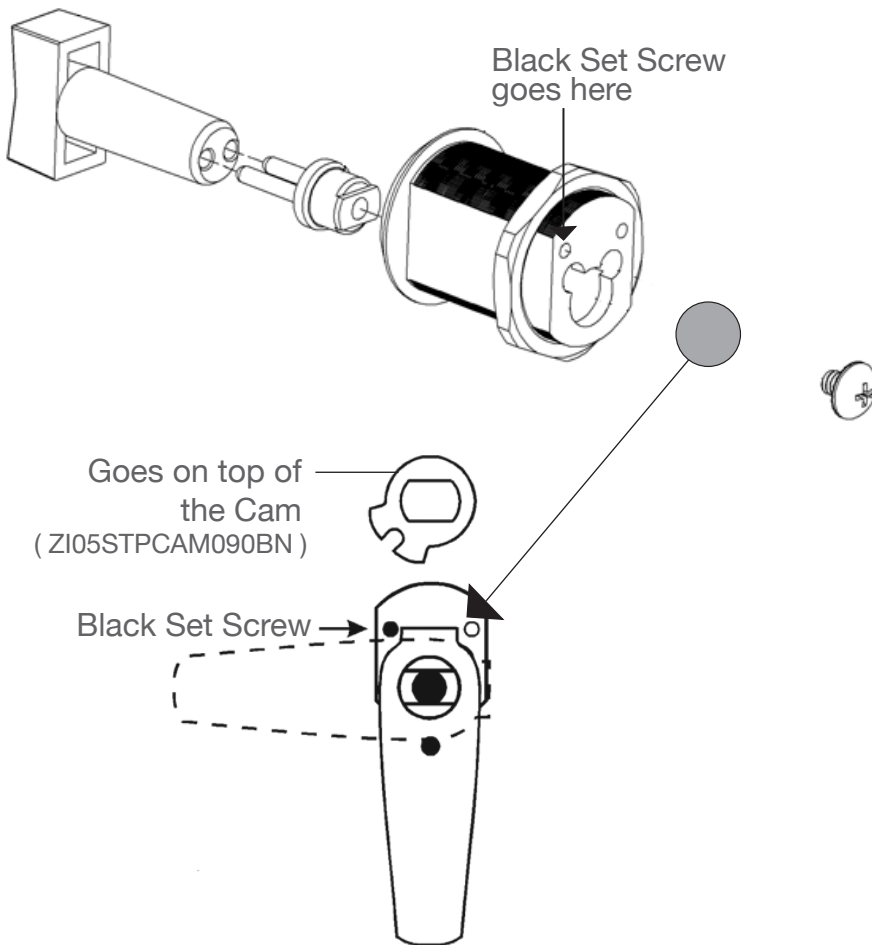

For this and more assembly/installation instructions go to www.kenstan.com click on Customer Support then click on "Installation Instructions"

WOOD INSTALLATION

Anti Rotation Plate

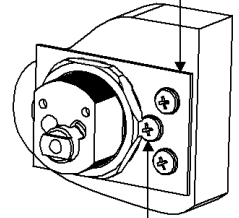

8 Screw used to secure large hex nut from backing out

METAL INSTALLATION

Anti Rotation Three Tab washer (tabs bent over to prevent nut from backing out)

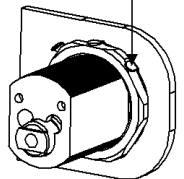

Note: A double "D" hole is required on the glass to prevent the lock from rotating.

GLASS INSTALLATION

Anti Rotation Three Tab washer (tabs bent over to prevent nut from backing out)

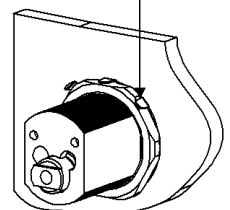

Note: A double "D" hole is required on the glass to prevent the lock from rotating.

CLI05-06 09N_
or
CLI05-0906N_

Kenstan

LOCK COMPANY

Manufacturer of Fine Showcase and Cabinet Locks

CLI05 I.C. Core Cam Lock Assembly Instructions

CLI05-06 09N_

Locked @ 6

Open @ 9

Not Key Retaining (key removable in locked or unlocked position)

or

CLI05-0906N_

Locked @ 9

Open @ 6

Not Key Retaining (key removable in locked or unlocked position)

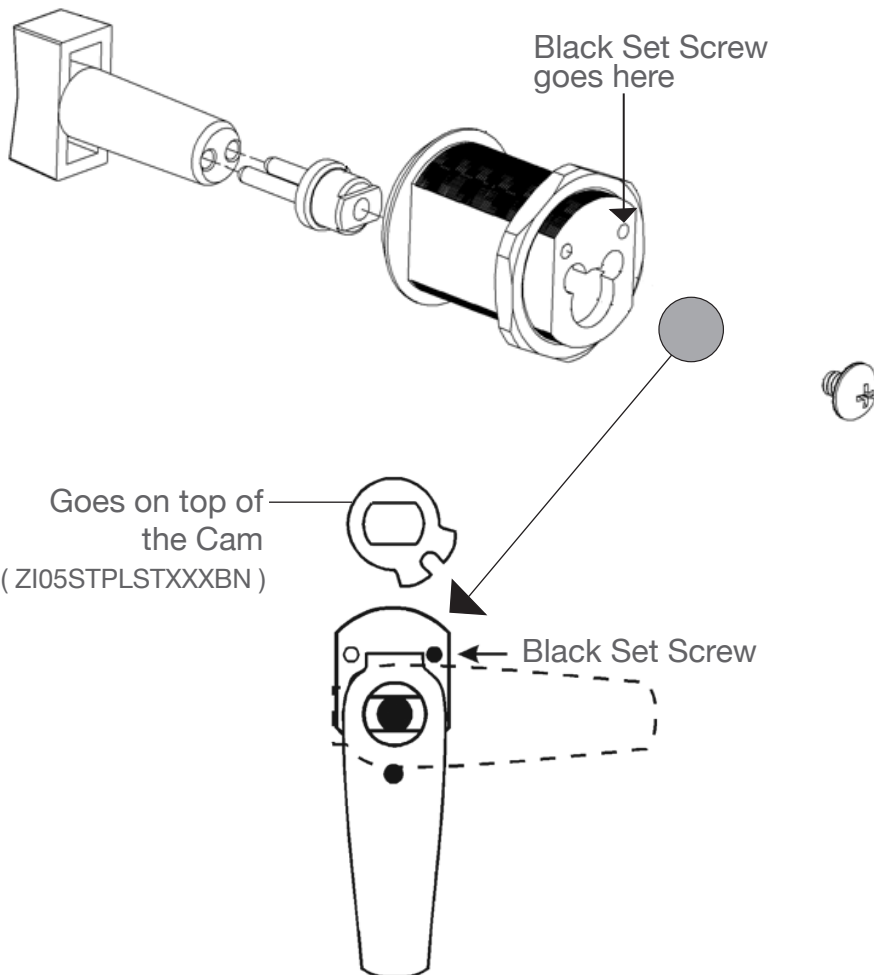

For this and more assembly/installation instructions go to www.kenstan.com click on Customer Support then click on "Installation Instructions"

WOOD INSTALLATION

Anti Rotation Plate

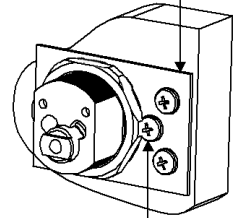

8 Screw used to secure large hex nut from backing out

METAL INSTALLATION

Anti Rotation Three Tab washer (tabs bent over to prevent nut from backing out)

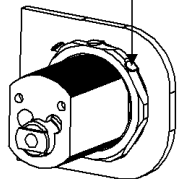

Note: A double "D" hole is required on the glass to prevent the lock from rotating.

GLASS INSTALLATION

Anti Rotation Three Tab washer (tabs bent over to prevent nut from backing out)

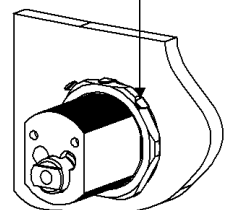

Note: A double "D" hole is required on the glass to prevent the lock from rotating.

CLI05-06 03Y_

Kenstan

LOCK COMPANY

Manufacturer of Fine Showcase and Cabinet Locks

CLI05 I.C. Core Cam Lock Assembly Instructions

CLI05-06 03Y_

Locked @ 6

Open @ 3

Key Retaining (key removable in locked position only)

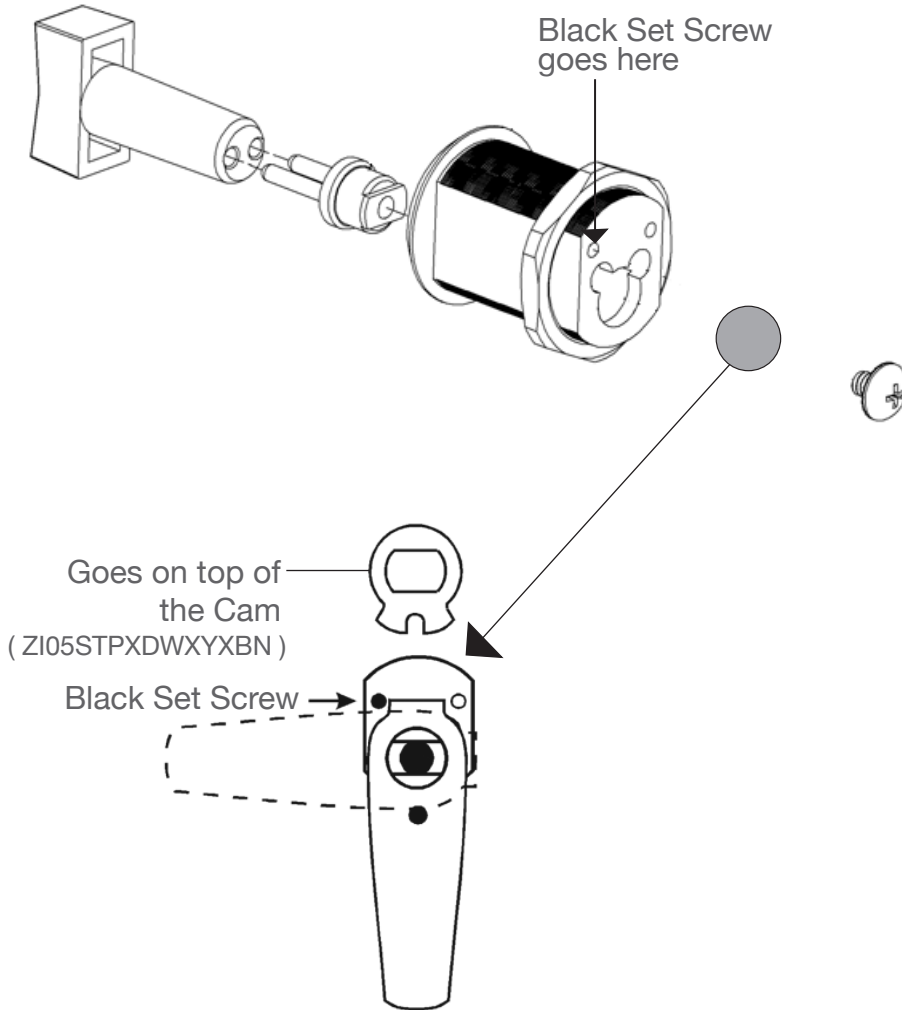

WOOD INSTALLATION

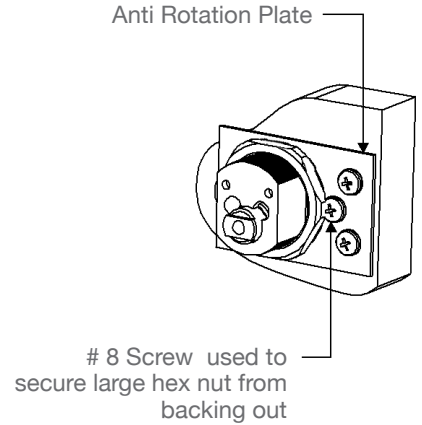

METAL INSTALLATION

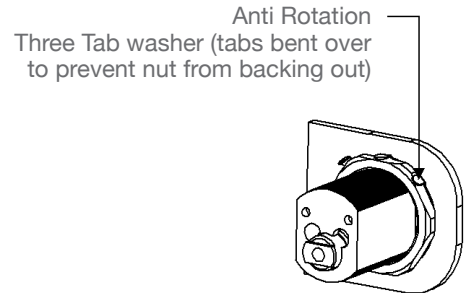

Note: A double "D" hole is required on the glass to prevent the lock from rotating.

GLASS INSTALLATION

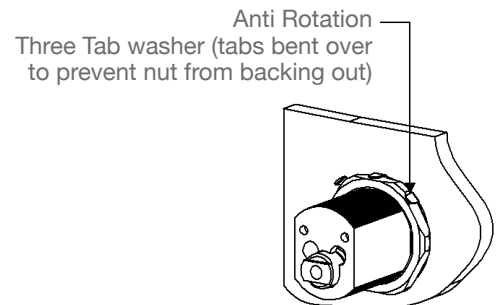

Note: A double "D" hole is required on the glass to prevent the lock from rotating.

For this and more assembly/installation instructions go to www.kenstan.com click on Customer Support then click on "Installation Instructions"

CLI05 I.C. Core Cam Lock Assembly Instructions

CLI05-06 09Y_

Locked @ 6

Open @ 9

Key Retaining (key removable in locked position only)

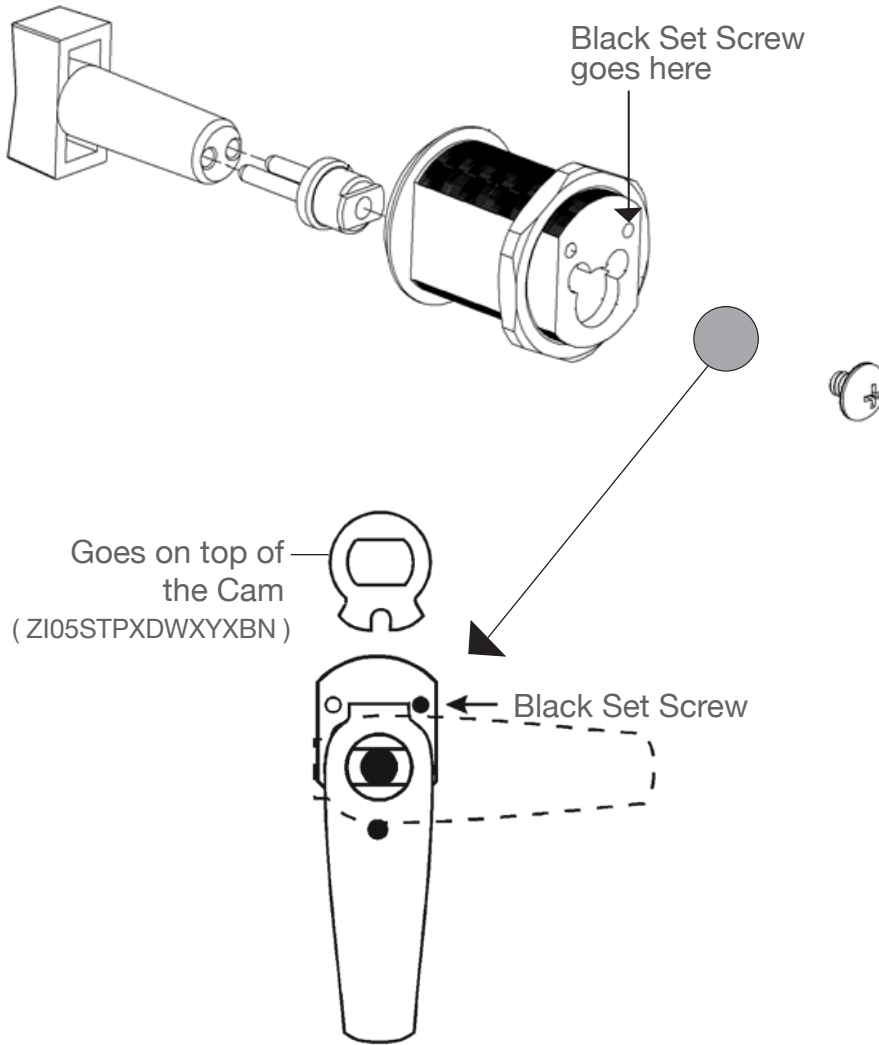

WOOD INSTALLATION

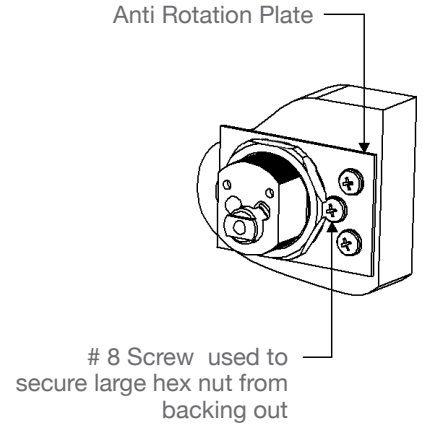

METAL INSTALLATION

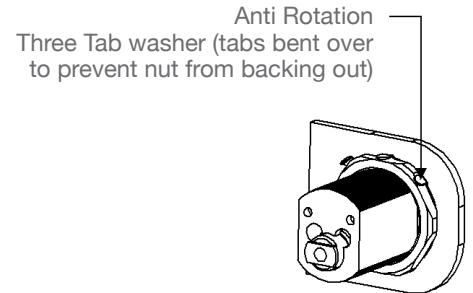

Note: A double "D" hole is required on the glass to prevent the lock from rotating.

GLASS INSTALLATION

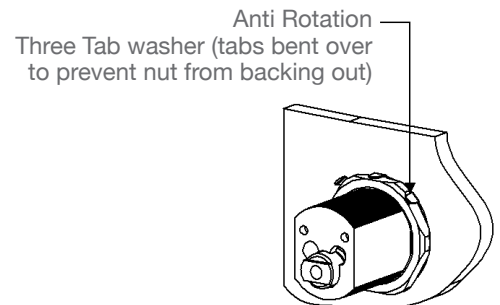

Note: A double "D" hole is required on the glass to prevent the lock from rotating.

For this and more assembly/installation instructions go to www.kenstan.com click on Customer Support then click on "Installation Instructions"

CLI05 I.C. Core Cam Lock Assembly Instructions

CLI05-09 06Y_

Locked @ 9

Open @ 6

Key Retaining (key removable in locked position only)

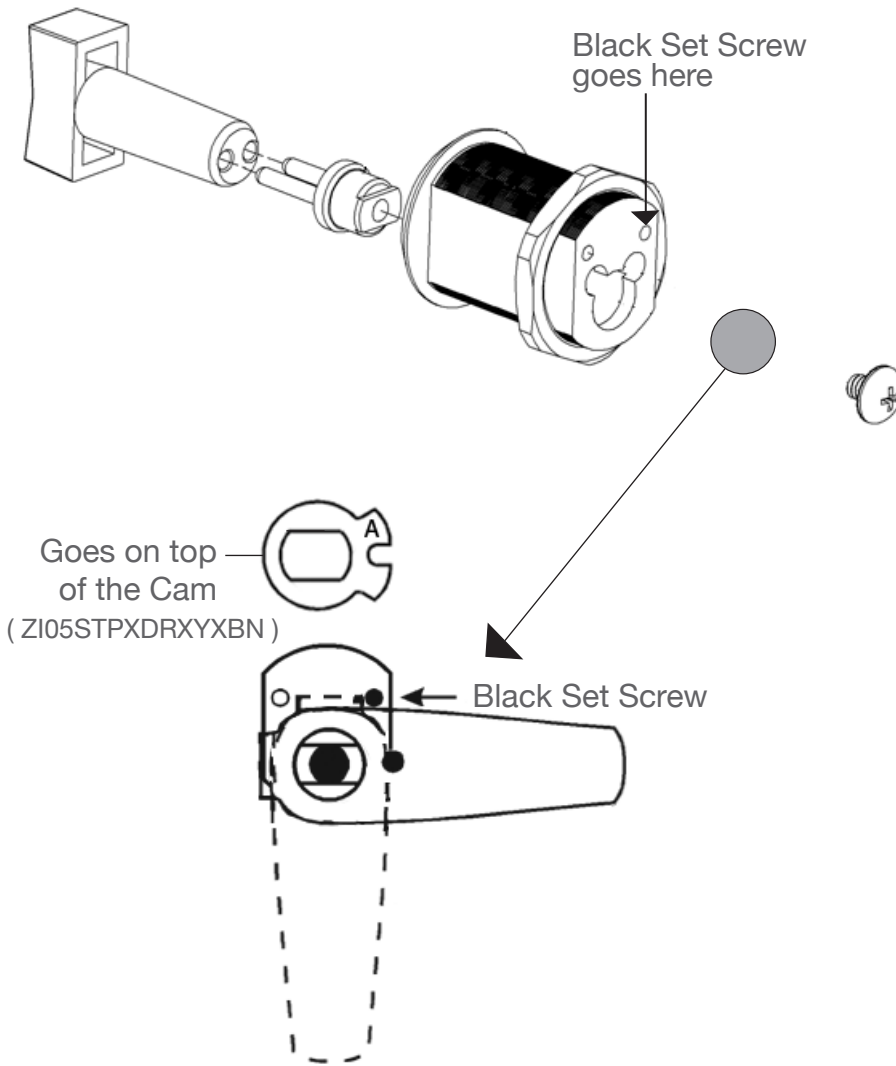

WOOD INSTALLATION

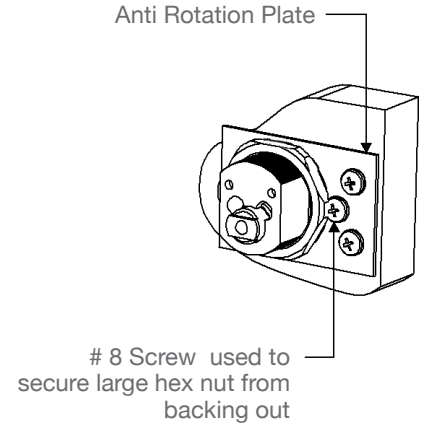

METAL INSTALLATION

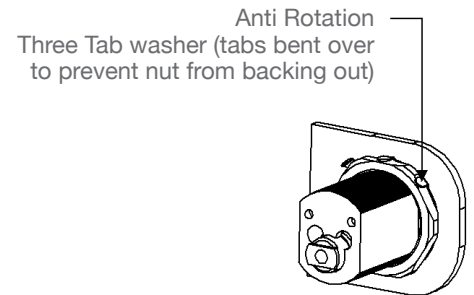

Note: A double "D" hole is required on the glass to prevent the lock from rotating.

GLASS INSTALLATION

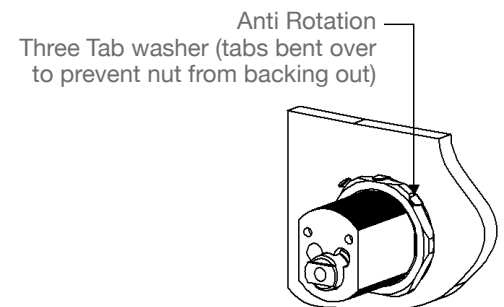

Note: A double "D" hole is required on the glass to prevent the lock from rotating.

For this and more assembly/installation instructions go to www.kenstan.com click on Customer Support then click on "Installation Instructions"

CLI05 I.C. Core Cam Lock Assembly Instructions

CLI05-03 06Y_

Locked @ 3

Open @ 6

Key Retaining (key removable in locked position only)

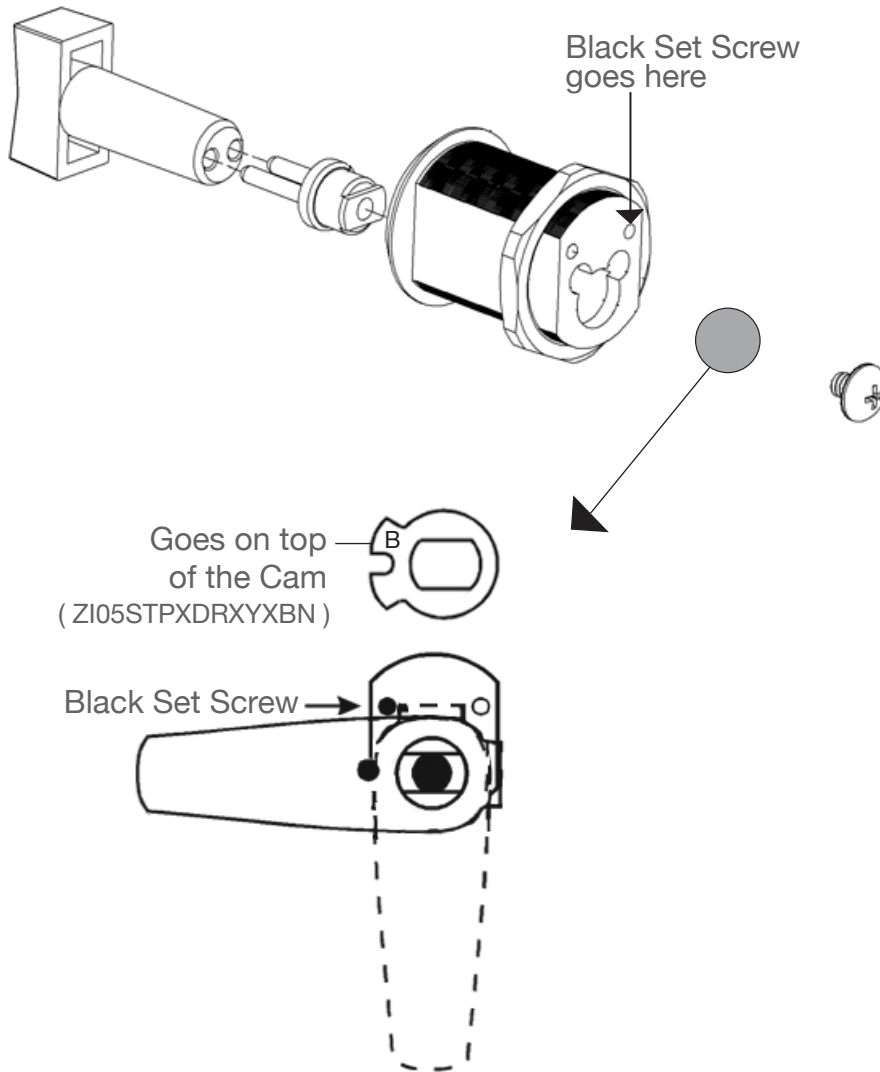

WOOD INSTALLATION

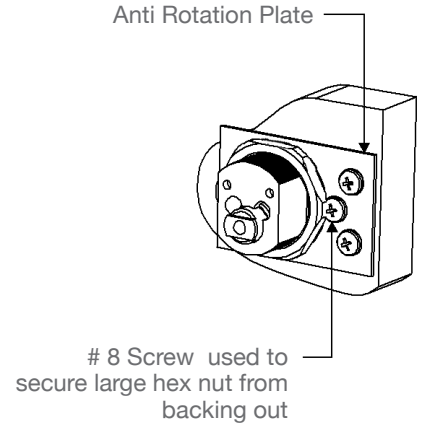

METAL INSTALLATION

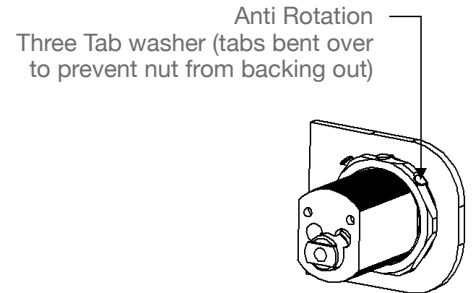

Note: A double "D" hole is required on the glass to prevent the lock from rotating.

GLASS INSTALLATION

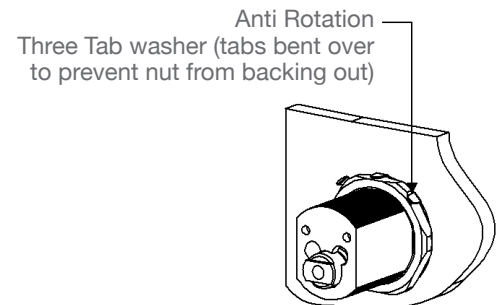

Note: A double "D" hole is required on the glass to prevent the lock from rotating.

For this and more assembly/installation instructions go to www.kenstan.com click on Customer Support then click on "Installation Instructions"